

# Table of Contents

c:geon käytön aloitus .....

2

*Registering c:geo with geocaching.com .....*

*2*

*Registering c:geo with Opencaching platforms .....*

*4*



**This page is not fully translated, yet. Please help completing the translation.**  
(remove this paragraph once the translation is finished)

## c:geon käytön aloitus



Käyttääksesi c:geota, tarvitset käyttäjätili valitsemallasi geokätköily sivustolla. c:geo tukee tällä hetkellä [geocaching.com](https://www.geocaching.com)ia, kansainvälistä kaupallista geokätköily sivustoa, myös Opencaching-sivustoa useissa maissa (kuten [Opencaching USA](https://www.opencaching.com), [Opencaching UK](https://www.opencaching.com), ja monta muuta). Valitse haluamasi sivusto, ja luo käyttäjätili etukäteen heidän omalla verkkosivulla (Peruskäyttäjän tili on yleensä ilmainen).

c:geo ei toimi ilman käyttäjätiliä!

### Registering c:geo with geocaching.com

If you start c:geo for the first time after installation, you will be directly taken to the service settings where you can enter your username and password for geocaching.com.

If you would like to access the service settings for geocaching.com again after the first start, you will find them in:

Menu → Settings → Services → geocaching.com

Click on the button Authorize c:geo as shown below::

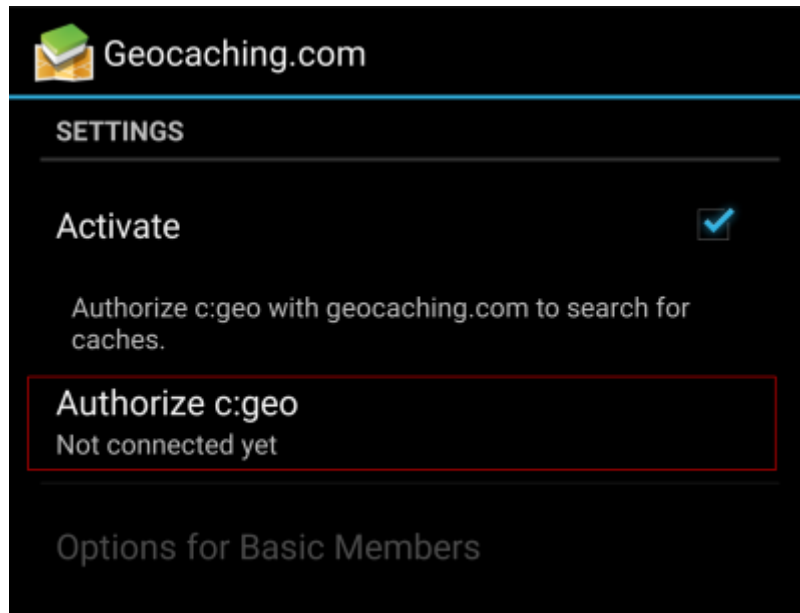

After clicking on Authorize c:geo a window will be shown, where you can enter your username and password for geocaching.com and finally click on Check authentication.

If you do not yet have an account, you may click on the button Create an account to open the registration page of geocaching.com.

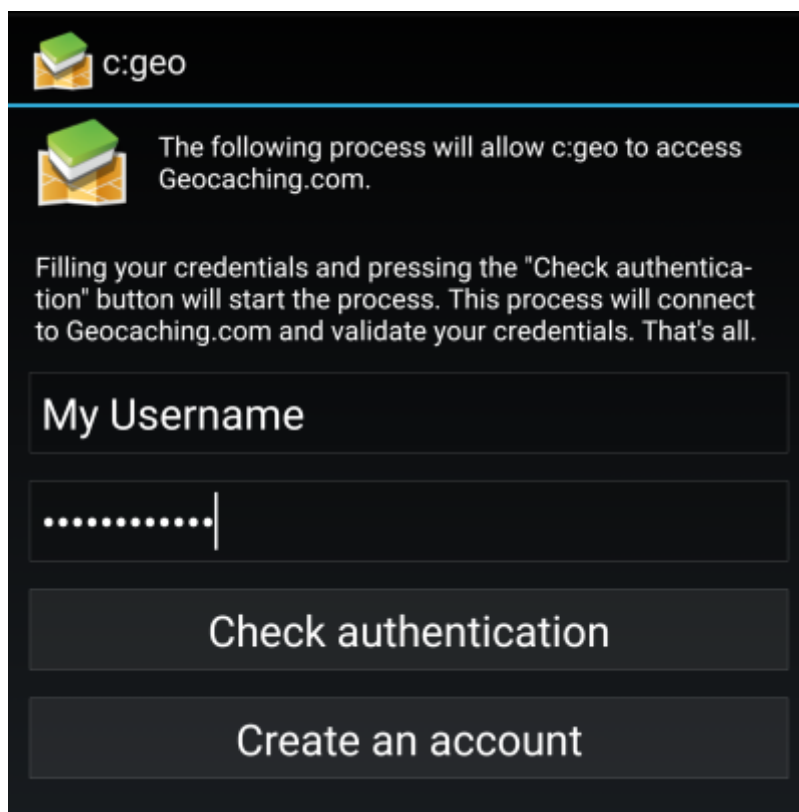
**c:geo**

---



The following process will allow c:geo to access Geocaching.com.

Filling your credentials and pressing the "Check authentication" button will start the process. This process will connect to Geocaching.com and validate your credentials. That's all.

**My Username**

.....|

**Check authentication**

**Create an account**

After completing the registration, c:geo will automatically return to the service menu and you can see the successful registration as your username and your avatar will be shown:

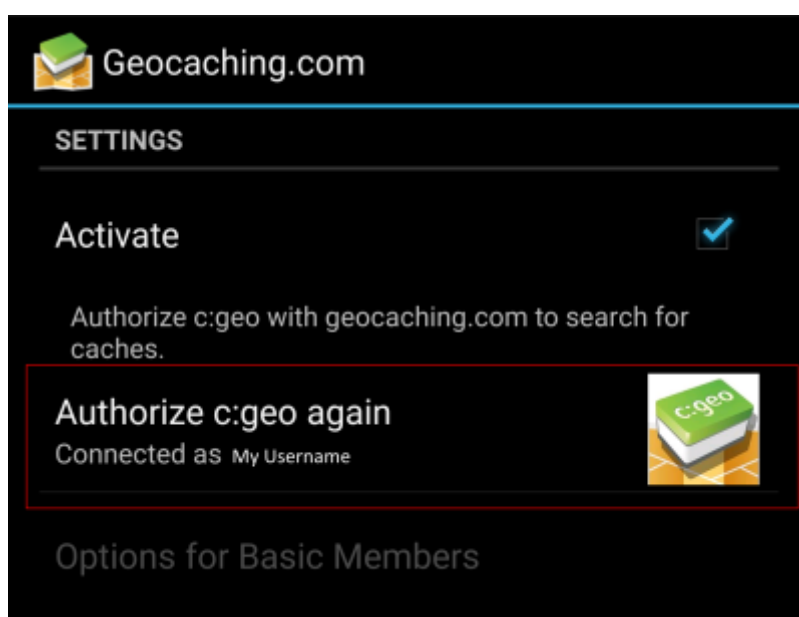
**Geocaching.com**

---

**SETTINGS**

---

**Activate** ☒

Authorize c:geo with geocaching.com to search for caches.

**Authorize c:geo again**   
Connected as **My Username**

Options for Basic Members



If the registration fails, please take a look in our [FAQ](#) to get help.

Now you just have to select the back function on your device to reach the main menu of c:geo. At next start of c:geo you will be automatically taken to the main menu.

## Registering c:geo with Opencaching platforms

If you want to connect c:geo with another service than geocaching.com or re-access the service settings, you will find them in:

Menu → Settings → Services



You can find more information regarding the geocaching services supported by c:geo [here](#).

Select a geocaching platform, which you want to connect with and activate the service in the following screen by clicking the Activate box. Afterwards start the authorization process by clicking on Authorize c:geo.

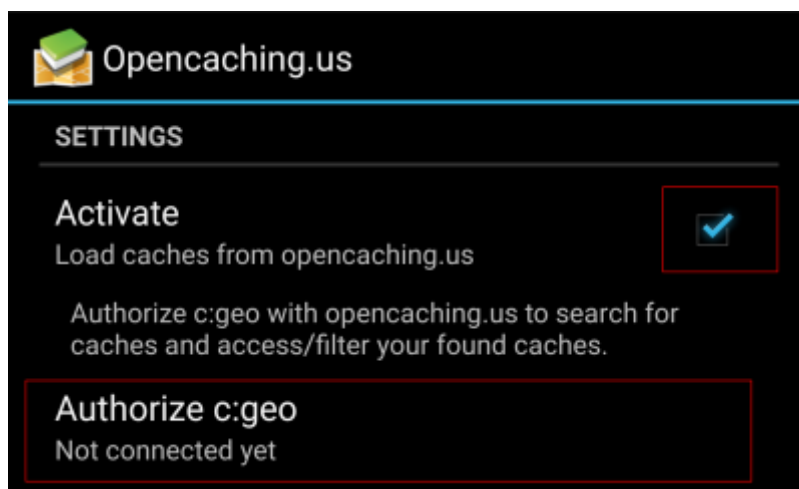

and Start authorization in the next screen. If you do not yet have an account, you may click on the button Create an account to open the registration page of the Opencaching platform.

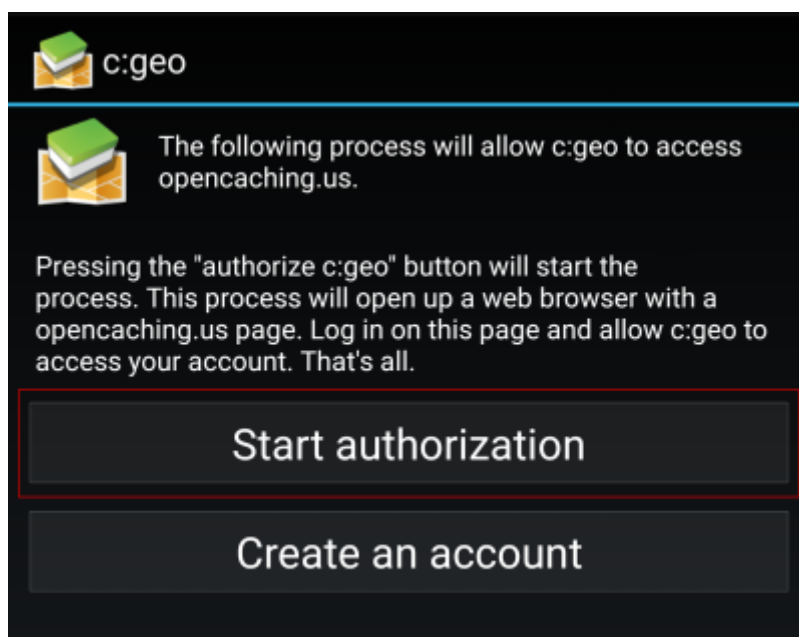

You will now be taken to the web page of the Opencaching platform in your browser. Login to the web page with your username and password and - where required - agree on the following page to give c:geo access to your Opencaching account.



The screenshot shows the OpenCaching website's login page. The browser address bar displays `www.opencaching.us/login.php?target=ol`. The page header includes the OpenCaching logo, the text "OPENCACHING Geocaching in North America", and a cartoon character. A navigation bar contains links: MAIN PAGE, OC WIKI, FORUM, BLOG, SOCIAL MEDIA, OCNA SWAG!, and TRACKABLES. On the left, a "MAIN MENU" sidebar lists various links. The main content area is titled "Login" and features a login form with fields for "Username:" (containing "My username") and "Password:" (containing "\*\*\*\*\*"). Below the fields are "Reset" and "Login" buttons. Links for "Not registered? Register" and "Forgot your password? Remind Me" are also present.

After completing the registration c:geo should open again and report the successful registration:

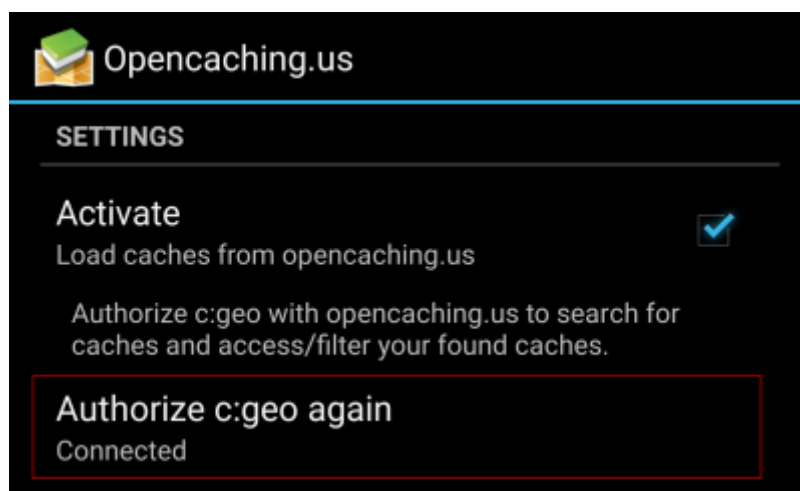

The screenshot shows the "SETTINGS" screen in the c:geo application. At the top is the OpenCaching.us logo. Under the "SETTINGS" header, the "Activate" option is checked, with the text "Load caches from opencaching.us". Below this, it says "Authorize c:geo with opencaching.us to search for caches and access/filter your found caches." A red-bordered box highlights the "Authorize c:geo again" option, which is currently set to "Connected".



If you receive an error message or you do not return to c:geo, please try to use another browser for registration. Please also check, if date and time on your device are correctly set.